

Case No: SPUD-1422 Applicant: Sipey Investments, LLC
Existing Zoning: R-1 / AE-2
Location: 8008 W.Wilshire Blvd.



Aerial Photo from 2/2020



The City of
OKLAHOMA CITY

Simplified Planned Unit Development

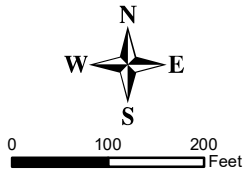

Case No: SPUD-1422 Applicant: Sipey Investments, LLC
Existing Zoning: R-1 / AE-2
Location: 8008 W.Wilshire Blvd.

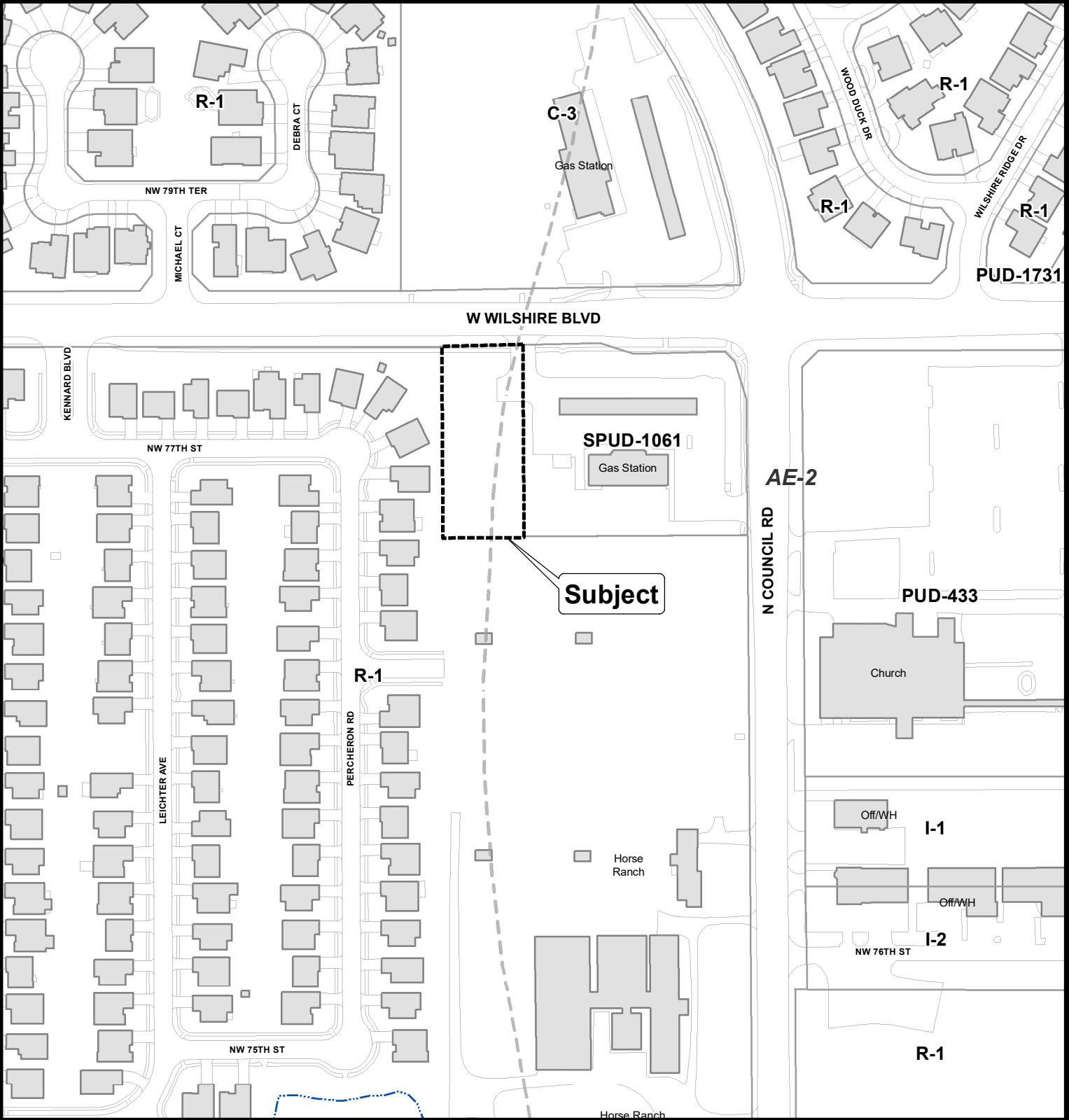

The City of
OKLAHOMA CITY

Simplified Planned Unit Development

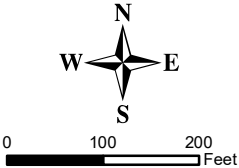

ATTACHMENT "A"
AVIGATION EASEMENT
SIEPEY INVESTMENTS, LLC
WILL ROGERS WORLD AIRPORT



W WILSHIRE BLVD

W WILSHIRE BLVD

W WILSHIRE BLVD

NW 76TH ST

N COUNCIL RD

AE-2

NW 76TH ST

AE-1

PERCHERON RD

6

5

N COUNCIL RD

NW 74TH ST

NW 74TH ST

WRWA

1 inch = 200 feet

WPA

